

---

**DATA SHEET. Model: PH2-1000E.**

---

Self-contained emergency floodlight with non-maintained functioning of the PH Series.



---

**Description**

---

Emergency floodlight for surface mounting.

Small metal body with epoxy paint RAL 7035 grey: watertight wall cabinet with lockable door.

Two fully adjustable LED spotlights with a concentrated light beam, suitable for great heights.

Supplied with a PG-11 cable gland for cable entry from the side.

---

**Technical characteristics**

---

Lamp in emergency	2 x LED White 5,000 K
Lamp in maintained	N/A
Flux in emergency	1.000 lm
Flux in maintained	N/A
Charge indicator	1 x LED green
Autonomy	2 h
Supply voltage	230 Vac - 50 Hz
Operation temperature	0 ÷ 40°C
Mains power	3.6 W
Battery	Ni-Cd (HT) 7.2 V - 3 Ah
Remote controllable	Yes (TL-300)
Protection rating	IP66 - IK08
Electrical insulation	Class I
Applicable legislation	CE marking (93/68/CEE): 2014/35/EU 2014/30/EU 2011/65/EU

---

**Photometric curve**

---

Cd/Klm

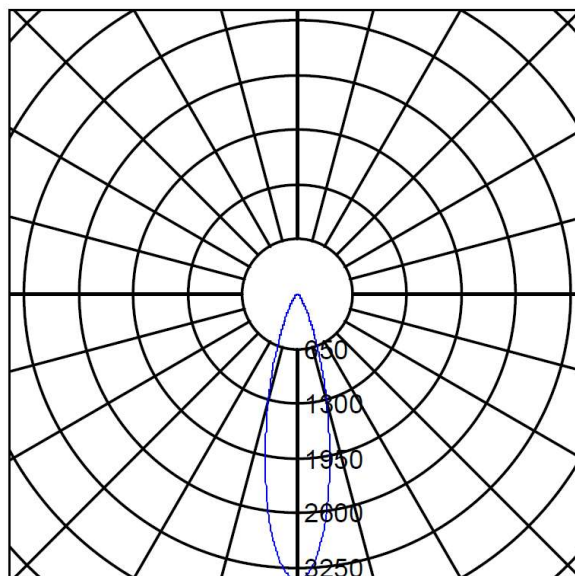

■ 0-180

---

DATA SHEET. Model: PH2-1000E \_ Rev. 01 (March 2024)



**LUZNOR Desarrollos Electrónicos, S.L.**

Paduleta, 47 · 01015 · Vitoria-Gasteiz · 945 200 961

NIF: B01266451 · luznor@luznor.com · www.luznor.com



## Dimensions

---

Surface mounting

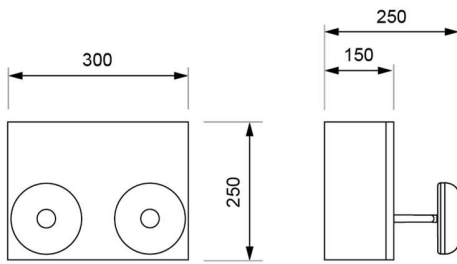

---

DATA SHEET. Model: PH2-1000E \_ Rev. 01 (March 2024)



**LUZ NOR Desarrollos Electrónicos, S.L.**  
Paduleta, 47 · 01015 · Vitoria-Gasteiz · 945 200 961  
NIF: B01266451 · luznor@luznor.com · www.luznor.com

